

# MODEL MPCW

**Size:** 11" x 9.5" x 4.125" (.28 x .24 x .10 m)

**Approximate weight:** 3.75 lbs. (1.59 kg)

**Display:** Bright LED **Keypad:** split and raised 40 key keyboard



## Advanced universal wireless control featuring:

- Convenient wireless operation within 1000'.
- Operates multiple scoreboards and accessories wireless and/or wired simultaneously with one control.
- Hand-held time switch for starting and stopping clock.
- High visibility LED display with sport-specific keyboard overlays.
- Ten year lithium battery maintains all scoreboard statistics in the event of a power failure.
- Retains user preferences and settings for easy reference.
- Segment timing feature ideal for practices and drills.

Combine your scoreboard with a Nevco monochrome or full-color message center to create a complete scoring and display system. Team/Sponsor signs also available.



BUILD YOUR OWN DISPLAY AND SCORING SYSTEM ONLINE AT:

**WWW.NEVCO.COM**

U.S. & CANADA: 800-851-4040 INTERNATIONAL: 618-664-0360

FAX: 618-664-0398 E-MAIL: INFO@NEVCO.COM

# INTEGRATED DISPLAY AND SCORING SOLUTIONS

## Model MPCW Operating Features

Alphanumeric LED display.

Operator keyboards.

Optional hand-held remote switch (will operate from either receptacle). Required for specific accessories.

Changeable keyboard sport-specific overlay.

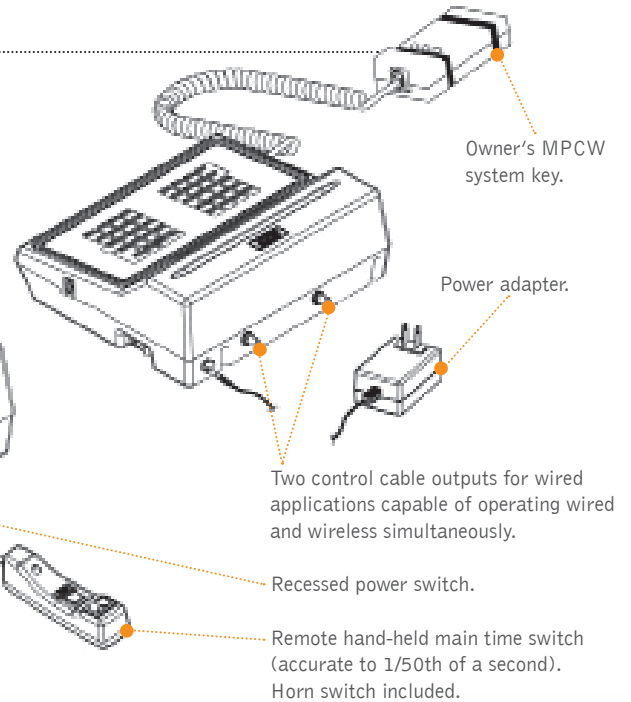

## MPCW Receiver

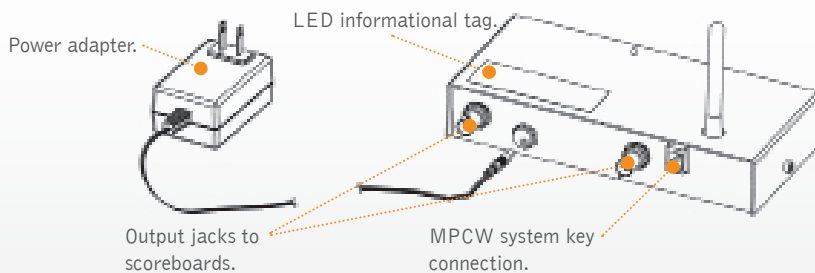

### OPTIONAL CARRYING CASE AVAILABLE:

The CC-3 double wall carrying case is lightweight and durable, made of high density polyethylene. Size 18 1/2" x 14 1/2" x 6". Black textured finish resists dents and scuffs. Case features trouble-free mechanical latches and hinges. Padded case interior is large enough for Nevco MPCW control, hand-held switch, and 25' of scoreboard control cable.



**CERTIFICATIONS:** UL/CUL listed, FCC, CE, INDUSTRY CANADA.

**MPCW CONTROL:** Microprocessor-based operator's control. Construction of gray high impact break-resistant plastic, size 11" x 9 1/2" x 4 1/8" (.28 x .24 x .10 m). Includes: remote hand-held time switch accurate to 1/50th of a second, horn button included on time switch and keyboard overlay. Control features: bright LED display, lithium cell battery backup to maintain scoreboard memory and time of day, self test mode, power on-off switch, alternate time control, internal beeper acknowledging each entry, bookmark capabilities and multiple scoreboard operation. Capable of operating wireless or wired scoreboard systems.

**TIMERS:** For scoreboards with timers, additional features: time of day display, multiple time out timers with warning, interval horn, upcount auto stop with horn. 1/10th seconds are displayed during the last minute.

**RANGE:** Maximum range of 1,000 feet from control to receiver.

**SYSTEM KEY:** Used during installation and configuration to set up your scoreboard system.

**MPCW RECEIVER:** Constructed of aluminum. Size 6 1/8 x 3 x 1 3/8" (.16 x .07 x .04 m) antenna height 4" (.10 m). For Indoor Installations, the receiver is mounted on top of scoreboard. Optional for Indoor Installations, the receiver is mounted in a junction box 8 x 8 x 6" (.21 x .21 x .16 m) for frequent access. For all Outdoor Installations, the receiver is mounted inside a rain tight junction box 8 x 8 x 6" (.21 x .21 x .16 m). Purchased separately.

**DIMMER:** Activated from control for scoreboard.

**POWER: WALL OUTLET POWER ADAPTER:** One required for each control and each receiver. Input: 100-120 Volts, .4 Amps, 50/60 Hz. Output: 9 volts, 1.67 Amps. Maximum 9 Volt output power 15 Watts.

**OPERATES MODELS:** All Nevco scoreboards except UltraScore, UltraWrestling, SEG-14, SEG-18, PCD and 9550.

**GUARANTEE:** TO VIEW OR RECEIVE THE MOST RECENT COPY OF OUR GUARANTEE, PLEASE VISIT: [NEVCO.COM/WARRANTY-LIMITATION](http://NEVCO.COM/WARRANTY-LIMITATION)

**U.S. SERVICE: 1-800-851-4040**

**INTERNATIONAL SERVICE: 1-618-664-0360**

**CANADA SERVICE: 1-800-461-8550**



**BUILD YOUR OWN DISPLAY AND SCORING SYSTEM ONLINE AT:**

**WWW.NEVCO.COM**

**U.S. & CANADA: 800-851-4040 INTERNATIONAL: 618-664-0360**

**FAX: 618-664-0398 E-MAIL: [INFO@NEVCO.COM](mailto:INFO@NEVCO.COM)**